

## Valve Rocker Arm and Push Rod Installation

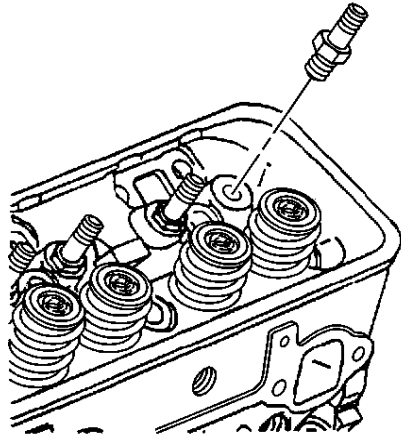

1. If reusing the fasteners, apply threadlock GM P/N 12345493 or equivalent to the threads of the valve rocker arm ball studs.

**Notice:** Refer to [Fastener Notice](#) in Cautions and Notices.

**Important:** Be sure to keep parts in order. Parts must be reinstalled into their original location and position.

2. Install the valve rocker arm ball studs.  
Tighten  
Tighten the valve rocker arm ball studs to 47 Y (35 lb ft).

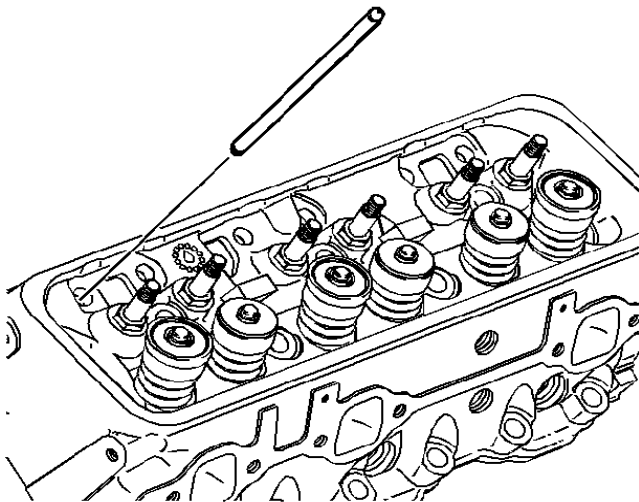

**Important:** Be sure that the valve pushrods seat in the valve lifter sockets.

© 2013 General Motors. All rights reserved.

3. Install the valve pushrods.

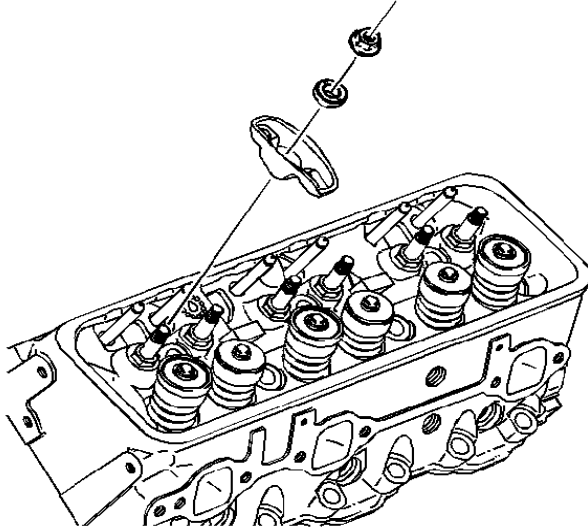

4. Apply prelube GMP/N 12345501 or equivalent to the valve rocker arm and valve rocker arm ball bearing surfaces.
5. Install the valve rocker arms.
6. Install the valve rocker arm balls.
- Important: Once the valve rocker arm nuts are installed and properly torqued, no additional valve lash adjustment is required.**
7. Install the valve rocker arm nuts.

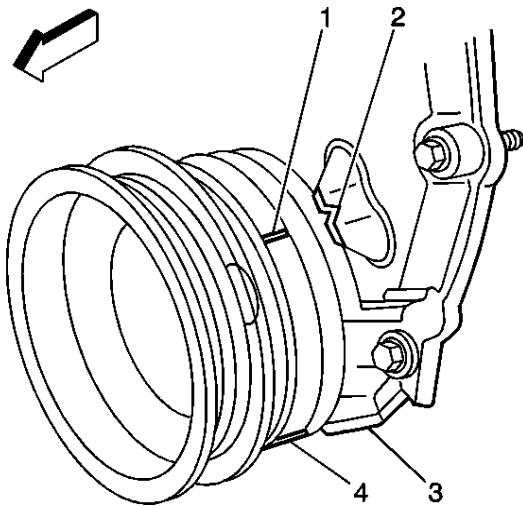

8. Rotate the crankshaft balancer to position the crankshaft balancer alignment mark (1) 57–63 degrees clockwise or counterclockwise from the engine front cover alignment tab (2).
9. Tighten the valve rocker arm nuts.  
Tighten  
Tighten valve rocker arm nuts to 25 Y (18 lb ft).