

<- Back

Forward ->

Document ID# 557146
2000 Chevrolet/Geo Blazer - 4WD

Print

Fuel Pressure Regulator Replacement

Removal Procedure

Tool Required

[J 34730-1A](#) Fuel Pressure Gauge

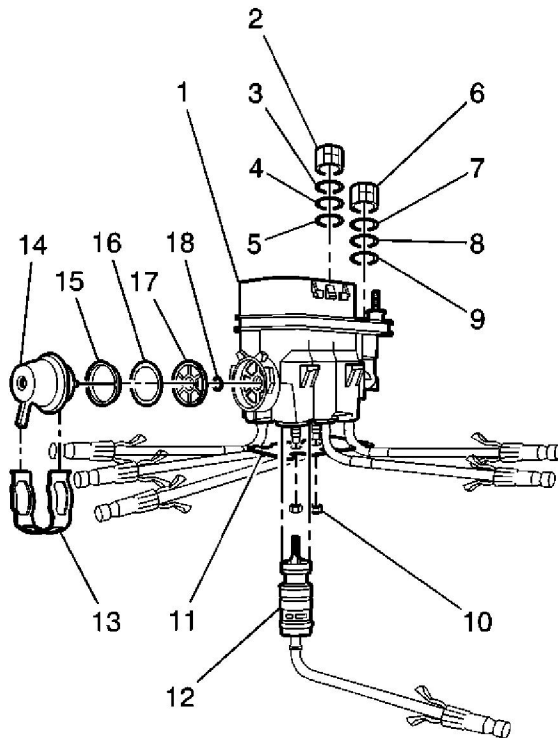

Caution

Before servicing any electrical component, the ignition key must be in the OFF or LOCK position and all electrical loads must be OFF, unless instructed otherwise in these procedures. If a tool or equipment could easily come in contact with a live exposed electrical terminal, also disconnect the negative battery cable. Failure to follow these precautions may

cause personal injury and/or damage to the vehicle or its components.

1. Disconnect the negative battery cable.
2. Relieve the fuel system pressure. Refer to [Fuel Pressure Relief Procedure](#).
3. Remove the upper intake manifold assembly. Refer to [Intake Manifold Replacement](#) in Engine Mechanical -- 4.3L.
4. Remove the fuel pressure regulator retainer clip (13).
5. Pull and twist the fuel pressure regulator (14) in order to remove the fuel pressure regulator from the fuel pressure regulator housing using a shop towel to catch any spilled fuel.
6. Remove the regulator seal lower O-ring (18).
7. Remove the regulator assembly filter (17).
8. Remove the regulator seal upper O-ring (16).
9. Remove the regulator seal backup ring (15).
10. Cover the fuel pressure regulator housing to prevent contamination from entering the fuel system.
11. Discard the O-rings.

Installation Procedure

Important

If the fuel pressure regulator is to be reinstalled, inspect the filter screen for contamination. If the filter screen is contaminated, replace the regulator.

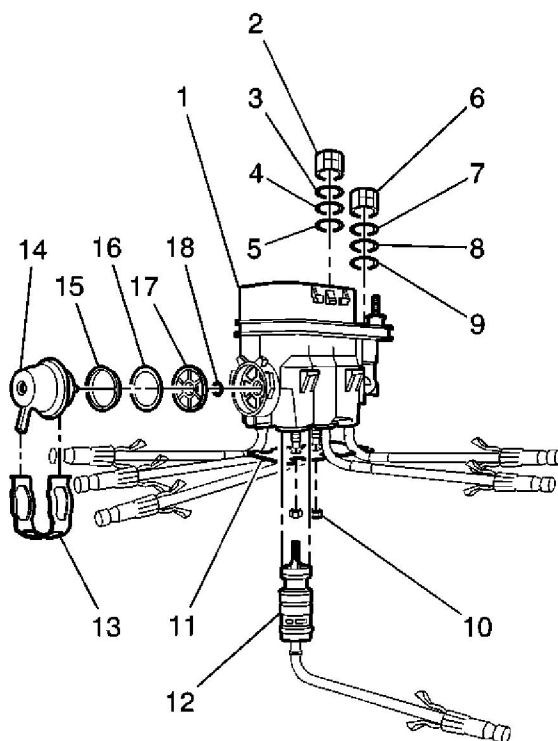



1. Lubricate the new O-rings with clean engine oil.
2. Install the regulator seal backup ring (15).
3. Install the regulator seal upper O-ring (16).
4. Install the regulator assembly filter (17).
5. Install the regulator seal lower O-ring (18).
6. Assemble the regulator with the vacuum tube pointing down into the regulator retainer clip.
7. Install the fuel pressure regulator retainer clip (13).
8. Install the upper manifold assembly. Refer to [Intake Manifold Replacement](#) in Engine Mechanical -- 4.3L.
9. Tighten the fuel filler cap.
10. Connect the negative battery cable.
11. Inspect for leaks.
 - A. Turn the ignition switch ON for 2 seconds.
 - B. Turn the ignition switch OFF for 10 seconds.
 - C. Turn the ignition switch ON.
 - D. Inspect for fuel leaks.

<- Back

Forward ->

Document ID# 557146
2000 Chevrolet/Geo Blazer - 4WD

Print