

< - Back

Forward ->

Document ID# 737108
2002 Chevrolet S10 Pickup - 2WD

Print

FIGURE Engine, LR (4.3L)(c)

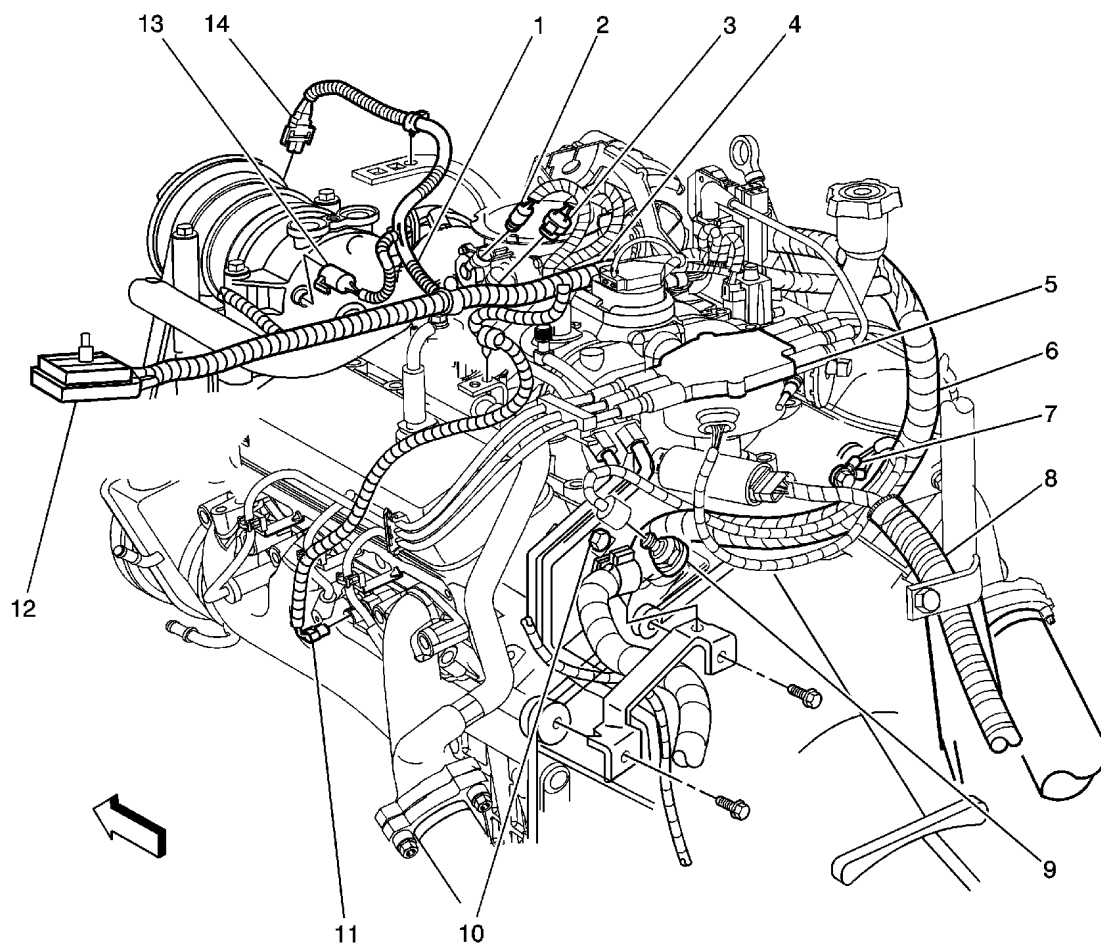

- (1) A/C Compressor Clutch Diode, S103, and S104
- (2) Throttle Position (TP) Sensor
- (3) Idle Air Control (IAC) Valve
- (4) S102
- (5) Distributor
- (6) S116
- (7) G102 and G103
- (8) S152
- (9) Knock Sensor (KS)
- (10) G105 and G104

- (11) Engine Coolant Temperature (ECT) Sensor
 - (12) Fuse Block - Underhood Connector C2 (BLK)
 - (13) A/C Compressor High Pressure Switch
 - (14) A/C Compressor
-

[<- Back](#)[Forward ->](#)

Document ID# 737108
2002 Chevrolet S10 Pickup - 2WD

[Print](#)